

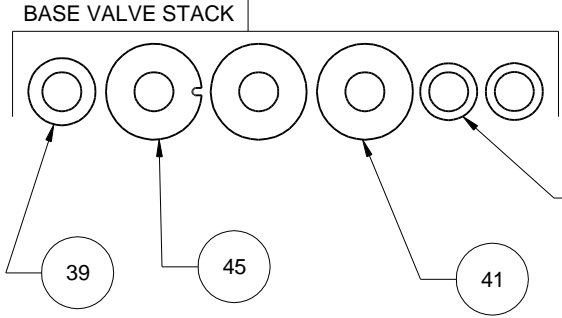

REVISIONS				
ZONE	REV	DESCRIPTION	DATE	APPROVED

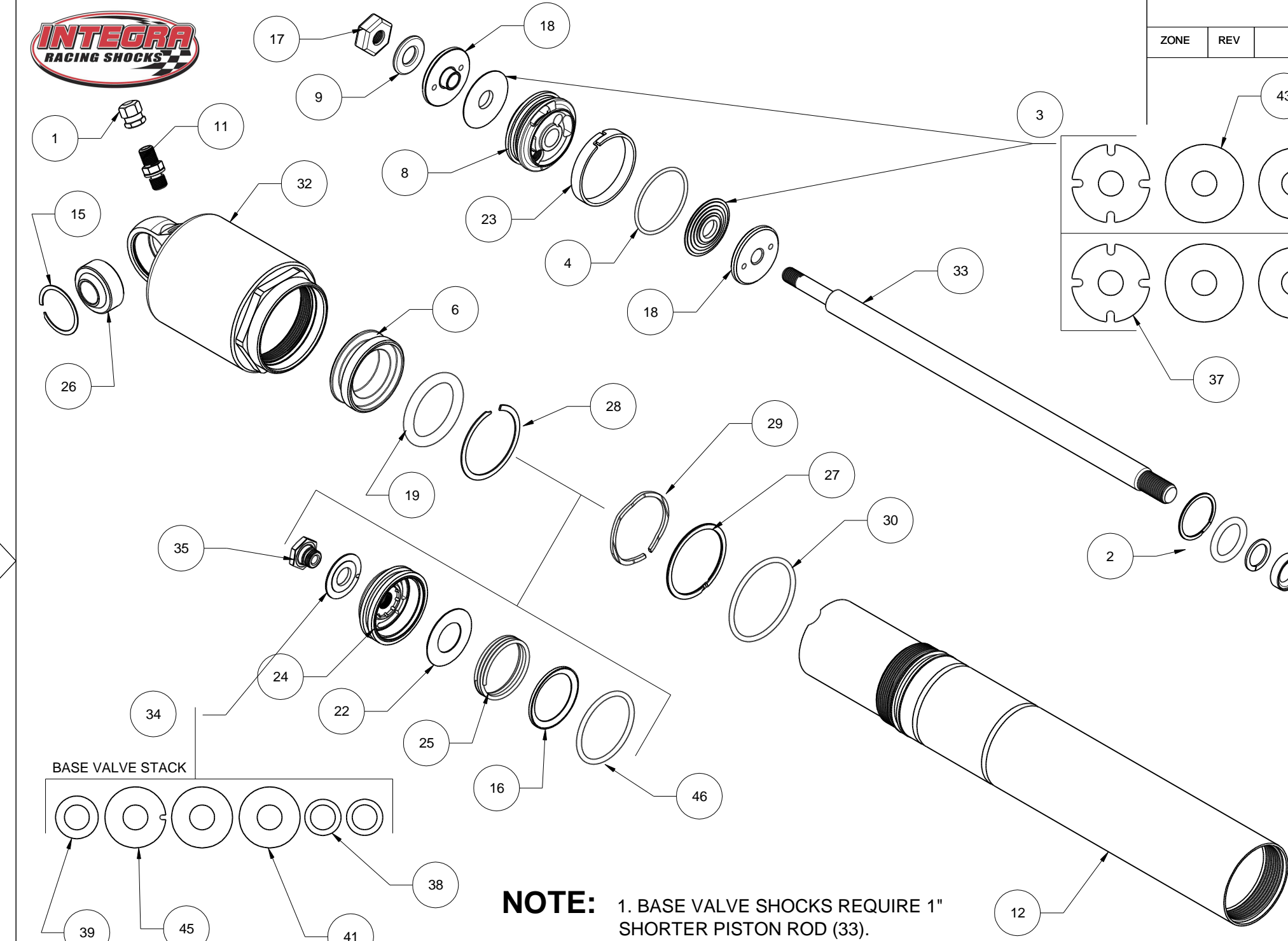
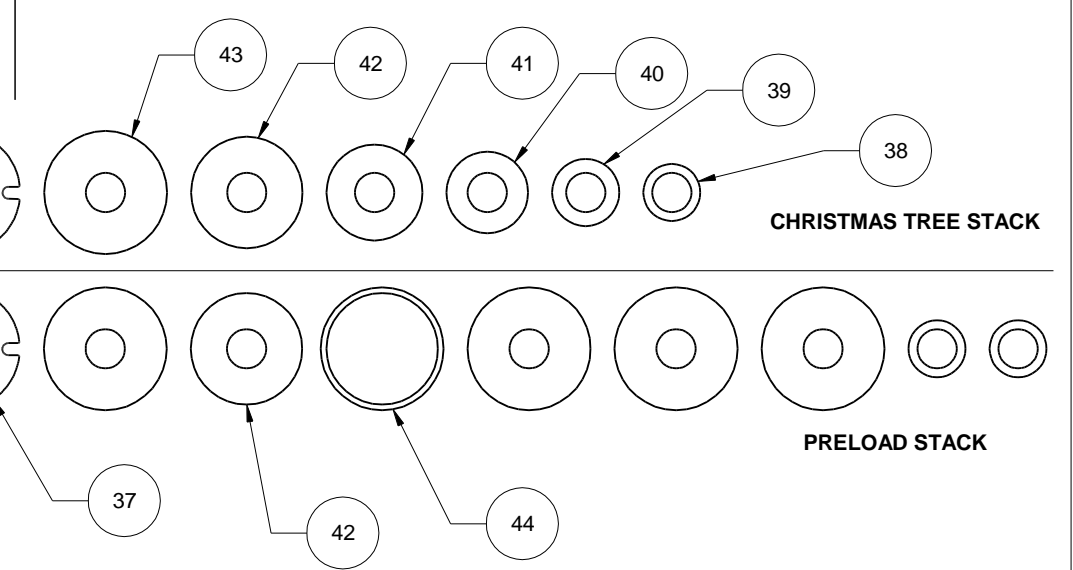

**NOTE:** 1. BASE VALVE SHOCKS REQUIRE 1" SHORTER PISTON ROD (33).

2. BASE VALVE SHOCKS CAN BE BUILT AS NSV BY CHANGING 310 30440X (32) TO 310 30441X

PART DESCRIPTION			
STEEL BODY BASE VALVE - EXPLODED			
MATERIAL		MATERIAL	
DRAWN BY		APPROVAL	
KWK		MLZ	
SIZE	FSCM NO.	DWG NO.	REV
B		310 402XXS	C
SCALE		SHEET	
1" = 2.5"		1 OF 2	

THIS DRAWING, INFORMATION, AND TECHNICAL DATA CONTAINED WITHIN ARE THE EXCLUSIVE PROPERTY OF INTEGRA RACING SHOCKS AND SHALL BE RETURNED UPON REQUEST. THIS DRAWING IS NOT TO BE REPRODUCED IN WHOLE OR IN PART, NOR SHALL ANY INFORMATION OR TECHNICAL DATA BE SUPPLIED, IN ANY FORM, TO ANYONE ELSE WITHOUT THE EXPRESS WRITTEN CONSENT OF INTEGRA RACING SHOCKS

BREAK EDGES .010 +/- 0.005" X 45°, FILLET RADIUS 0.010" +/- 0.005" TOLERANCES (UOS): .XX +/- .01", .XXX +/- .003", ANG +/- 0.5° ALL SURFACE FINISHES TO BE Ra 64 OR BETTER UNLESS OTHERWISE SPECIFIED.