

5

4

3

2

1



REVISIONS					
ZONE	REV.	DESCRIPTION	DATE	APPROVED	EPCN NO.
	A	ASSEMBLY CREATED	4/19/2019	KWK	

E

E

D

D

C

C

B

B

A

A

ITEM NO.	PART NUMBER	PART DESCRIPTION	QTY.
1	310 30214	PISTON BAND	1
2	310 30215	PISTON O-RING	1
3	310 30218	TRAVEL INDICATOR	1
4	310 30300	ROD GUIDE, STANDARD ASSEMBLY	1
5	310 30377	1/2-20 X 11/16 HEX JAM NUT, ADJUSTABLE	1
6	310 30382-20S	CANISTER HOSE ASSEMBLY	1
7a	310 30408-50	DBL ADJ END CAP ASSY	1
7b	310 3041X	ADJUSTABLE PRESSURE TUBE	1
8	310 31012-10	NEEDLE CAN ASSEMBLY, NO HOSE, BLADDER	1
9	310 44064	O-RING, NEEDLE	1
10	310 48035	INTERNAL SNAP RING	1
11	310 48052	NUT, PISTON	1
12	310 48054-XXX	INTEGRAL POST, POPPET HOUSING - .170	1
13	310 48055	WASHER - ADJUSTER POPPET HOUSING	1
14	310 48066	INTEGRAL POST, POPPET	1
15	310 48067	INTEGRAL POST POPPET SPRING	1
16		PISTON OF CHOICE	1
17	310 4838X	INTEGRAL POST, PISTON ROD W/ RING	1
18	310 48396	TRAVEL LIMITER, 1.42" X .502"	1
19	310 48396-1	TRAVEL LIMITER - DISC, INTEGRAL POST	1
20	310 60031	ADJUSTER KNOB, IDA	1
21	310 9003X	STD ROD END, INTEGRAL SHAFT ASSEMBLY	1
22	310 9036X-09	INTEGRAL ADJUSTER SHAFT - 9° NEEDLE	1
23	310 90TW070020	90000 SERIES TORQUE WASHER, Ø.700"	4
24		90MVD COMPRESSION STACK	1
25		90MVD REBOUND STACK	1

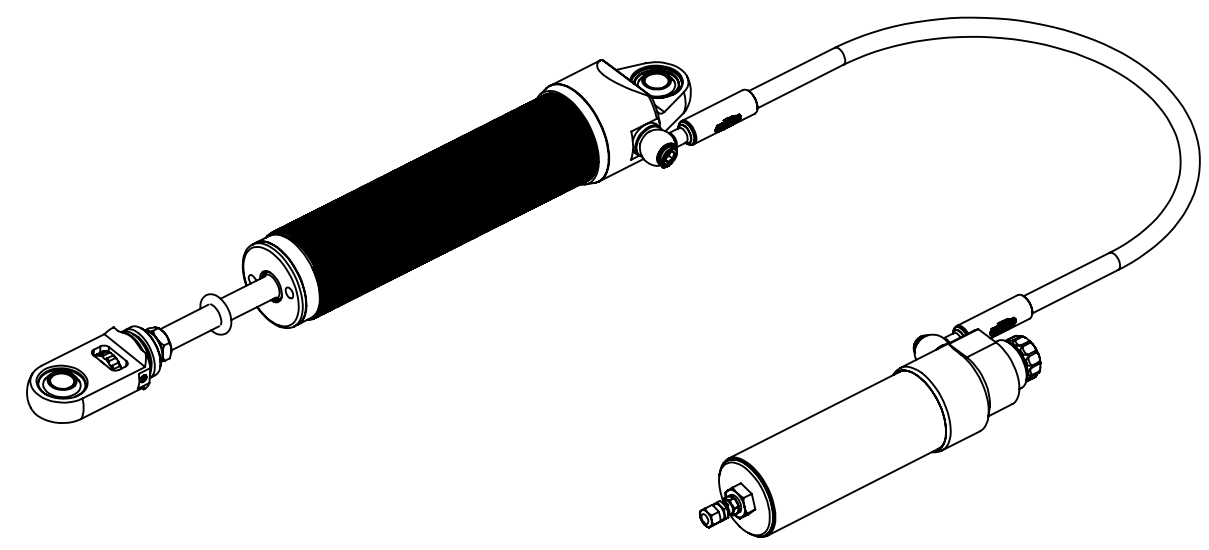

WEIGHT (lbs)	3.498	PART DESCRIPTION			
S.A. (in ²)	590.797	CANISTER, DOUBLE-ADJUSTABLE SHOCK			
MATERIAL		RELATIVE TO COMPONENTS			
DWG. NO		DRAWN BY		APPROVAL	
310 404XX		EKM		KWK	
SIZE	SCALE	SHEET		REV	
B	1:4	1 OF 2		A	

BREAK EDGES .010 +/- 0.005" X 45°, FILLET RADII 0.010" +/- 0.005"
 TOLERANCES (UOS): .XX +/- .01", .XXX +/- .003", ANG +/- 0.5°

ALL SURFACE FINISHES TO BE Ra 64 OR BETTER UNLESS OTHERWISE SPECIFIED.

THIS DRAWING, INFORMATION, AND TECHNICAL DATA CONTAINED WITHIN ARE THE EXCLUSIVE PROPERTY OF INTEGRA SHOCKS AND SHALL BE RETURNED UPON REQUEST. THIS DRAWING IS NOT TO BE REPRODUCED IN WHOLE OR IN PART, NOR SHALL ANY INFORMATION OR TECHNICAL DATA BE SUPPLIED, IN ANY FORM, TO ANYONE ELSE WITHOUT THE EXPRESS WRITTEN CONSENT OF INTEGRA SHOCKS.

5

4

3

2

1

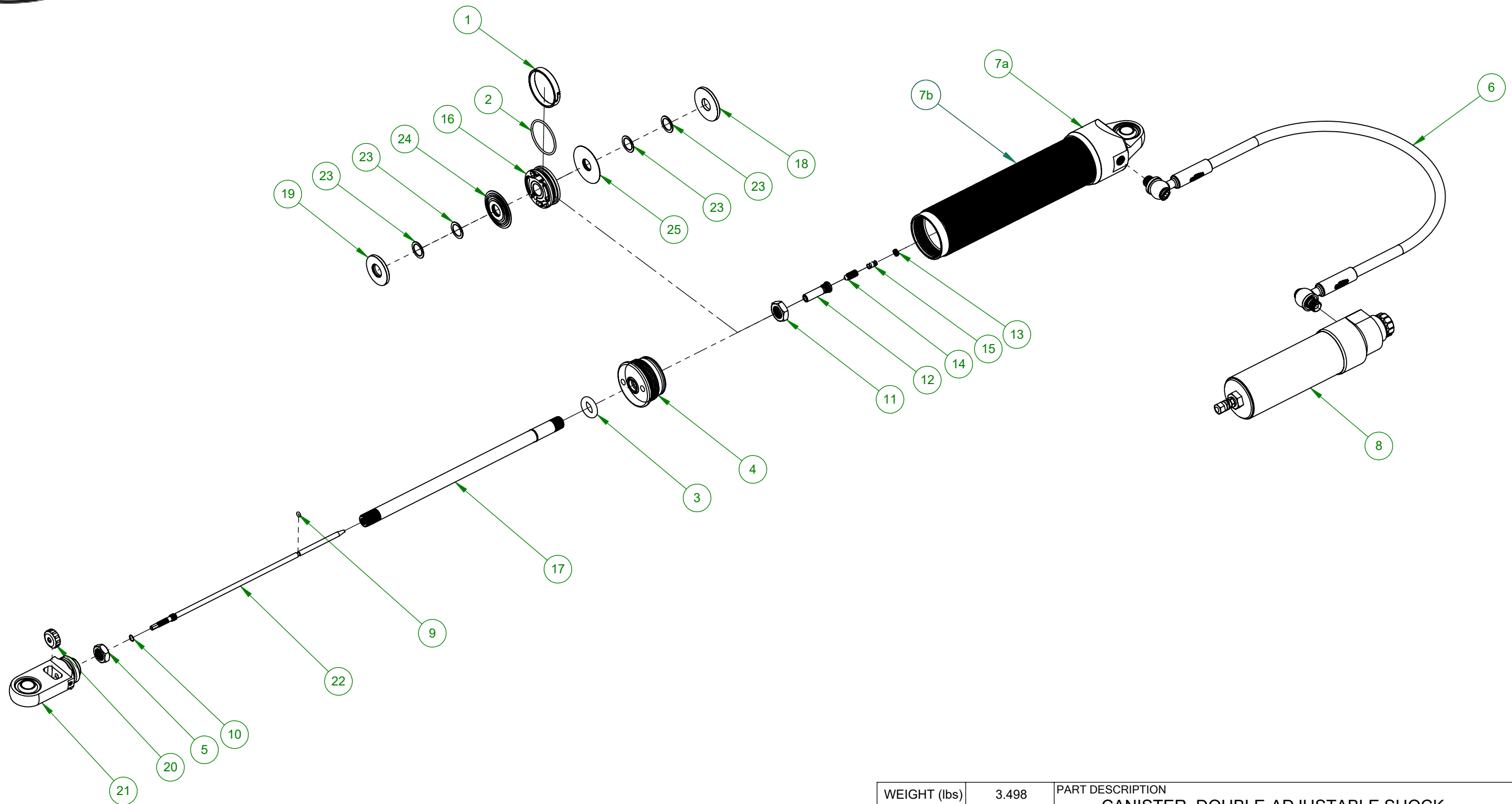

WEIGHT (lbs)		3.498		PART DESCRIPTION	
S.A. (in ²)		590.797		CANISTER, DOUBLE-ADJUSTABLE SHOCK	
MATERIAL				RELATIVE TO COMPONENTS	
DWG. NO		DRAWN BY		APPROVAL	
310 404XX		EKM		KWK	
SIZE	SCALE	SHEET		REV	
B	1:4	2 OF 2		A	

BREAK EDGES .010 +/- 0.005" X 45°, FILLET RADII 0.010" +/- 0.005"
 TOLERANCES (UOS): .XX +/- .01", .XXX +/- .003", ANG +/- 0.5°

ALL SURFACE FINISHES TO BE Ra 64 OR BETTER UNLESS OTHERWISE SPECIFIED.

THIS DRAWING, INFORMATION, AND TECHNICAL DATA CONTAINED WITHIN ARE THE EXCLUSIVE PROPERTY OF INTEGRA SHOCKS AND SHALL BE RETURNED UPON REQUEST. THIS DRAWING IS NOT TO BE REPRODUCED IN WHOLE OR IN PART, NOR SHALL ANY INFORMATION OR TECHNICAL DATA BE SUPPLIED, IN ANY FORM, TO ANYONE ELSE WITHOUT THE EXPRESS WRITTEN CONSENT OF INTEGRA SHOCKS.

5

4

3

2

1

E

E

D

D

C

C

B

B

A

A

5

4

3

2

1